

DIMENSIONS DES SUPPORTS

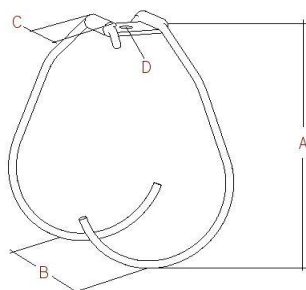

Supports de broche

CODE	H01-075	H01-100	H01-150
Diam.mm	75	100	150
A, mm	194	213	314
B, mm	110	110	127
C, mm	31	31	38
D, mm	11	11	13

Supports à bande simple

A technical drawing of a simple band support. It shows a U-shaped frame with a central hole. Dimension A is the total height, B is the width at the base, C is the width at the top, D is the width of the inner opening, F is the thickness of the top flange, G is the thickness of the side flange, H is the width of the top flange, and T is the thickness of the top flange.

CODE	H03-200	H03-250	H03-300	H03-375
Diam.mm	200	250	300	375
A, mm	257	305	368	451
B, mm	38	38	38	50
C, mm	381	406	470	578
D, mm	257	298	349	448
F, mm	9	9	9	12
G, mm	3	3	3	6
H, mm	330	356	419	527
T, mm	13	13	13	19

Supports à bande double

A technical drawing of a double band support. It shows a U-shaped frame with a central hole, featuring two parallel bands. Dimension A is the total height, B is the width at the base, C is the width at the top, D is the width of the inner opening, E is the width of the side flange, F is the thickness of the top flange, G is the thickness of the side flange, H is the width of the top flange, and T is the thickness of the top flange.

CODE	H-04 -200	H-04 -250	H-04 -300	H-04 -375
Diam.mm	200	250	300	375
A, mm	257	305	368	451
B, mm	203	203	203	305
C, mm	381	406	470	578
D, mm	257	298	349	448
E, mm	127	127	127	205
F, mm	9	9	9	12
G, mm	3	3	3	6
H, mm	330	356	419	527
T, mm	13	13	13	19

Fabrication de supports sur mesure possible.

Les produits de 450 à 600 mm seront disponibles ultérieurement.